

Mounting accessories for cylinders

Mountings in aluminium for cylinders ISO 15552



Main features

32 ÷ 320 **ISO** CMS..ALIS+V

Bores Ø MP6 Type

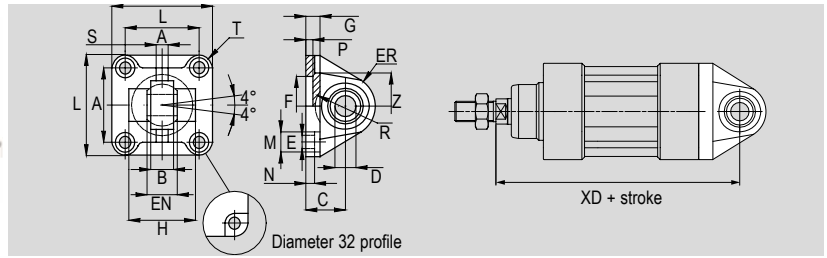

Technical data

Type	Description	Material	Treatment
CMS..ALIS+V	Mounting for cylinders in aluminium. Narrow rear eye with spherical bearing DIN 648K. Supplied with screws.	Die-cast aluminium	Sifting

Dimensions

For cylinder Ø mm	Code	Item	A	B	C	D	EN	ER	F	G	E	L	M	N	P	H	R	S	Z	T	XD	Weight (g)
32	042101	CMS032ALIS+V	32,5	10,5	22	10	14	16	30	9	6,6	45	11	5,5	5	-	-	4	32,5	6,25	142	-
40	042102	CMS040ALIS+V	38	12	25	12	16	19	35	9	6,6	52	11	5,5	5	-	-	6	39	7	160	-
50	042103	CMS050ALIS+V	46,5	15	27	16	21	21	40	11	9	65	15	6,5	5	51	18	8	47	9,25	170	-
63	042104	CMS063ALIS+V	56,5	15	32	16	21	24	45	11	9	75	15	6,5	5	-	-	8	52	9,25	190	-
80	042105	CMS080ALIS+V	72	18	36	20	25	28,5	45	14	11	95	18	10	5	72	24	10	67	11,5	210	-
100	042106	CMS100ALIS+V	89	18	41	20	25	30	55	14	11	115	18	10	5	-	-	10	77	13	230	-
125	042107	CMS125ALIS+V	110	25	50	30	37	40	60	20	13,5	140	20	10	7	-	-	13	98	15	275	-
160	042108	CMS160ALIS+V	140	28	55	35	43	45	65	20	18	180	26	10	7	-	-	14	130	20	315	-
200	042109	CMS200ALIS+V	175	28	60	35	43	48	75	25	18	220	26	11	7	-	-	14	155	22,5	335	-
250	042160	CMS250ALIS+V	220	33	70	40	49	52	90	25	22	270	33	11	11	-	-	19	205	25	375	-
320	040197	CMS320ALIS+V	270	45	80	50	60	63	110	30	22	350	33	11	11	-	-	-	-	28	420	-

Main features

32 ÷ 200 **ISO** FLV..ALIS+V

Bores Ø **VDMA** Type MF1/MF2

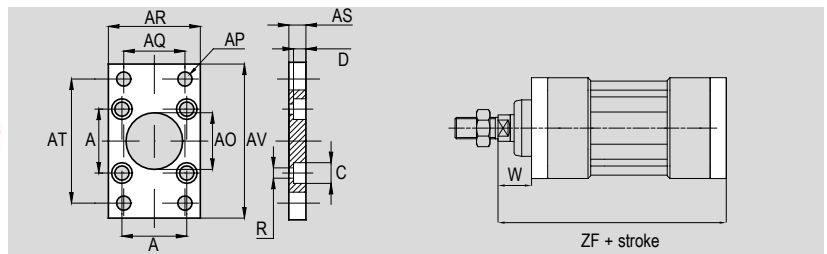

Technical data

Type	Description	Material	Treatment
FLV..ALIS+V	Mounting for cylinders in aluminium. Flange. For front or rear mounting. Supplied with screws.	Die-cast aluminium	Anodizing

Dimensions

For cylinder Ø mm	Code	Item	A	ØAP	AO	R	AS	AR	AQ	AT	AV	C	D	ZF	W	Weight (g)
32	042150	FLV032ALIS+V	32,5	7	30	6,5	10	45	32	64	86	10,5	5	130	16	-
40	042151	FLV040ALIS+V	38	9	35	6,5	10	52	36	72	96	11	5	145	20	-
50	042152	FLV050ALIS+V	46,5	9	40	9	12	65	45	90	115	15	5,5	155	25	-
63	042153	FLV063ALIS+V	56,5	9	45	9	12	75	50	100	130	15	5,5	170	25	-
80	042154	FLV080ALIS+V	72	12	45	11	16	95	63	126	165	18	7	190	30	-
100	042155	FLV100ALIS+V	89	14	55	11	16	115	75	150	187	18	7	205	35	-
125	042156	FLV125ALIS+V	110	16	60	13	20	140	90	180	224	19	9,5	245	45	-
160	042157	FLV160ALIS+V	140	18	65	17	20	180	115	230	280	25	10,5	280	60	-
200	042158	FLV200ALIS+V	175	22	75	17	25	220	135	270	320	25	12,5	300	70	-