

According to
ISO 4414/
DIN EN 983/ BIA

Safety Self-Venting Couplings

with Sleeve Concept - single shut-off Series ESAIS

- Top-quality, ergonomic and very robust one-hand quick connect couplings made of brass MS 58 nickel-plated with hardened steel sleeve and perfect sealing as well as compact dimensions
- Plug profile according to ISO 6150 B and US Mil.-Spec. C4109
- Very easy to connect, disconnection in two steps by pushing and pulling the sleeve in direction of arrow. Self-venting after step 1, safe decoupling after step 2
- Safe protection against whiplash-effect at best usability
- For safe handling of flexible compressed air lines
- High flow rates with low pressure drop due to patented OptiFlow by **LUDECKE**® valve technology
- **Attention: safe operation can only be guaranteed when using hardened steel plugs**

Materials

- Body, valve body: Brass MS 58 nickel-plated • Valve: Brass MS 58 plain
- Sleeve, plug: Hardened steel nickel-plated
- Seals: NBR (other materials on request) • Springs: Stainless steel 1.4310 • Balls: Stainless steel 1.4034

Max. Work. Pressure	Temperature	DN	Thread	Flow Rate	Operation	Type of Valve	Media	Area	
PN 12 bar	-20°C – +100°C	5.5	ISO 228/DIN EN 10226	1100 l/min	One-hand	Single Shut-off	Compr. Air	USA, F, SP	Coupl. 5 / Plug 10

Couplings with tapered male thread (thread coated)

Thread connection	L	SW	D	L1	Weight	Type No.
R 1/4 m	62	19	28	11	138	ESAIS 14 A
R 3/8 m	63	19	28	12	147	ESAIS 38 A
R 1/2 m	65	22	28	15	144	ESAIS 12 A

Couplings with parallel female thread

Thread connection	L	SW	D	L1	Weight	Type No.
G 1/4 f	58	19	28	10	146	ESAIS 14 I
G 3/8 f	58	19	28	10	144	ESAIS 38 I
G 1/2 f	60	24	28	12	160	ESAIS 12 I

Couplings with hose barb

Hose connection	L	SW	D	L1	Weight	Type No.
Hose i.D. 6	75	19	28	25	136	ESAIS 6 T
Hose i.D. 8	75	19	28	25	136	ESAIS 8 T
Hose i.D. 9	75	19	28	25	138	ESAIS 9 T
Hose i.D. 10	75	19	28	25	138	ESAIS 10 T
Hose i.D. 13	75	19	28	25	141	ESAIS 13 T

For hose clips type ZOS (☺ page 130), type HS (☺ page 131) or crimping ferrules type LPH (☺ page 133)

Plugs with tapered male thread (thread coated)

Thread connection	L	SW	L1	L2	Weight	Type No.
R 1/8 m	38	13	9	24	19	ESAI 18 NAS
R 1/4 m	41	14	12	24	25	ESAI 14 NAS
R 3/8 m	42	17	13	24	35	ESAI 38 NAS
R 1/2 m	48	22	17	24	55	ESAI 12 NAS

Plugs with parallel female thread

Thread connection	L	SW	L1	L2	Weight	Type No.
G 1/8 f	36	14	9	24	22	ESAI 18 NIS
G 1/4 f	36	17	9	24	25	ESAI 14 NIS
G 3/8 f	36	19	9	24	25	ESAI 38 NIS
G 1/2 f	39	24	12	24	40	ESAI 12 NIS

Plugs with hose barb

Hose connection	L	D	L1	L2	Weight	Type No.
Hose i.D. 6	48	14	23	24	15	ESAI 6 SS
Hose i.D. 8	48	14	23	24	17	ESAI 8 SS
Hose i.D. 9	48	14	23	24	18	ESAI 9 SS
Hose i.D. 10	48	14	23	24	20	ESAI 10 SS
Hose i.D. 13	48	14	23	24	25	ESAI 13 SS

For hose clips type ZOS (☺ page 130), type HS (☺ page 131) or crimping ferrules type LPH (☺ page 133)

DN 5.5

Plug Profile (original size)

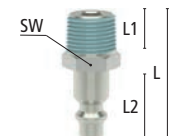
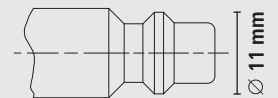

Opti®
Flow
by LUDECKE

