



MDH 420

DIFFERENTIAL HIGH PRESSURE INDICATOR

420 bar
operating pressure

1,5 to 80 °C
operating temperature range

DESCRIPTION

Magnetic differential manometer MDH 420 is designed to indicate pressure drop across the filter element in compressed air system.

It detects when the filter cartridge is clogged and should be replaced. MDH 420 is usually installed on the head of the filter housing.

Double dials on manometer allows readout values from both sides of the differential manometer. Thanks to resistance stainless steel housing is also suitable for demanding applications.

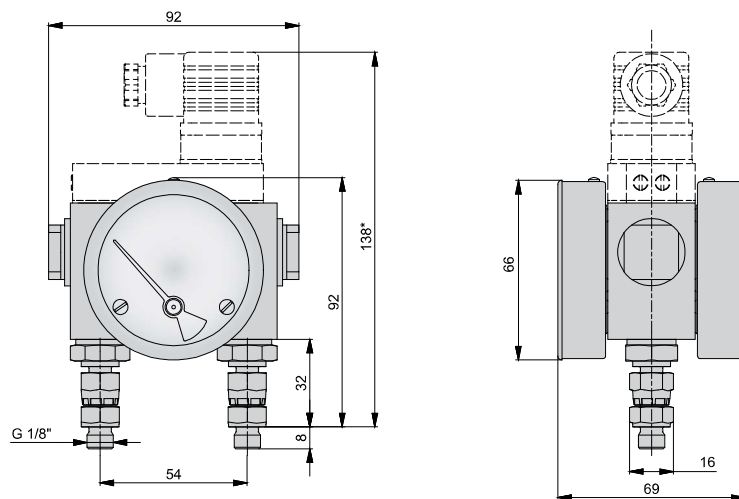

APPLICATIONS

- Automotive
- Electronics
- Food and beverage
- Chemical
- Petrochemical
- Plastics
- Paint
- General industrial application

TECHNICAL DATA

Ambient temperature range	1,5 - 80 °C	35 - 175°F
Measuring range	0 - 1 bar	0 - 14,7 psi
Static pressure	420 bar	6091 psi
Protection class	IP 65	
Accuracy	±5 % of full scale	
Connection	On body G1/4"female - reducing fittings G1/8" male	
Model	Description	
MDH 420	basic version	
MDH 420C	voltage-free contact version for remote alarm	