

# MDH 200

## DIFFERENTIAL HIGH PRESSURE INDICATOR



**200 bar**  
operating pressure

**1,5 to 80 °C**  
operating temperature range



### DESCRIPTION

Magnetic differential manometer MDH200 is designed to indicate pressure drop across the filter element in compressed air system.

It detects when the filter cartridge is clogged and should be replaced. MDH200 is usually installed on the head of the filter housing.

Double dials on manometer allows readout values from both sides of the differential manometer.

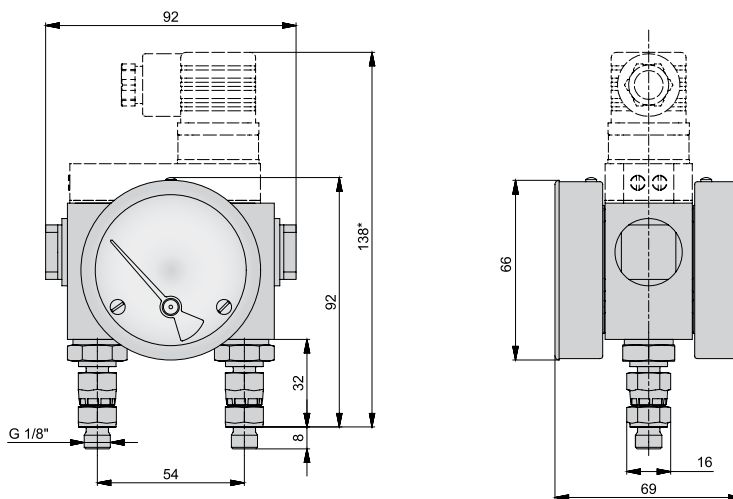

TECHNICAL DATA		
Ambient temperature range	1,5 - 80 °C	35 - 175°F
Measuring range	0 - 1 bar	0 - 14,5 psi
Static pressure	200 bar	2900 psi
Protection class	IP 64	
Accuracy	±5 % of full scale	
Connection	2 x G 1/8" male	
Model	Description	
MDH 200	basic version	
MDH 200C	voltage-free contact version for remote alarm	

### APPLICATIONS

- Automotive
- Electronics
- Food and beverage
- Chemical
- Petrochemical
- Plastics
- Paint
- General industrial application