

Hydraulické adaptéry

se závitý JIC 37° dle norem ISO 8434-2 a SAE J514

Úhlové adaptéry 90° - vnější závit JIC 37° × vnější G-závit s o-kroužkem						
Obj. č.	T1 závit JIC 37°	T2 závit BSPP	L1 (mm)	L2 (mm)	S (mm)	S1 (mm)
HJ07-71618	JIC 7/16"-20	G 1/8"	23	27	11	14
HJ07-71614	JIC 7/16"-20	G 1/4"	27	32	14	19
HJ07-71638	JIC 7/16"-20	G 3/8"	29	27	19	22
HJ07-1218	JIC 1/2"-20	G 1/8"	24	27	13	14
HJ07-1214	JIC 1/2"-20	G 1/4"	27	32	14	19
HJ07-1238	JIC 1/2"-20	G 3/8"	29	37	19	22
HJ07-91614	JIC 9/16"-18	G 1/4"	27	32	14	19
HJ07-91638	JIC 9/16"-18	G 3/8"	29	37	19	22
HJ07-91612	JIC 9/16"-18	G 1/2"	31	43	22	27
HJ07-3414	JIC 3/4"-16	G 1/4"	32	37	19	19
HJ07-3438	JIC 3/4"-16	G 3/8"	32	37	19	22
HJ07-3412	JIC 3/4"-16	G 1/2"	34	43	22	27
HJ07-3434	JIC 3/4"-16	G 3/4"	36	50	27	36
HJ07-7838	JIC 7/8"-14	G 3/8"	37	36	22	22
HJ07-7812	JIC 7/8"-14	G 1/2"	37	43	22	27
HJ07-7834	JIC 7/8"-14	G 3/4"	39	50	27	36
HJ07-171612	JIC 1 1/16"-12	G 1/2"	42	50	27	27
HJ07-171634	JIC 1 1/16"-12	G 3/4"	42	50	27	36
HJ07-171610	JIC 1 1/16"-12	G 1"	45	52	33	41
HJ07-211634	JIC 1 5/16"-12	G 3/4"	46	47	33	36
HJ07-211610	JIC 1 5/16"-12	G 1"	46	52	33	41
HJ07-13854	JIC 1 5/8"-12	G 1 1/4"	52	57	41	50
HJ07-15815	JIC 1 7/8"-12	G 1 1/2"	59	61	48	55

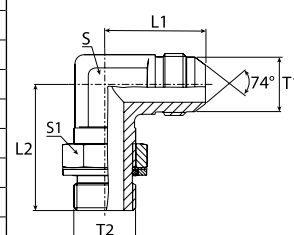

Úhlové adaptéry 45° - vnější závit JIC 37° × vnější G-závit s podložkou						
Obj. č.	T1 závit JIC 37°	T2 závit BSPP	L1 (mm)	L2 (mm)	S (mm)	S1 (mm)
HJ08-71618	JIC 7/16"-20	G 1/8"	18	27	11	14
HJ08-71614	JIC 7/16"-20	G 1/4"	21	29	14	19
HJ08-91614	JIC 9/16"-18	G 1/4"	21	29	14	19
HJ08-91638	JIC 9/16"-18	G 3/8"	22	33	19	22
HJ08-91612	JIC 9/16"-18	G 1/2"	22	39	22	27
HJ08-3438	JIC 3/4"-16	G 3/8"	25	33	19	22
HJ08-3412	JIC 3/4"-16	G 1/2"	25	39	22	27
HJ08-7812	JIC 7/8"-14	G 1/2"	28	39	22	27
HJ08-7834	JIC 7/8"-14	G 3/4"	30	44	27	36
HJ08-171634	JIC 1 1/16"-12	G 3/4"	33	44	27	36
HJ08-211610	JIC 1 5/16"-12	G 1"	37	47	33	41

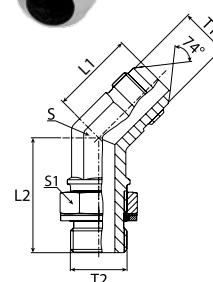

T-adaptéry - s vnějšími závití JIC 37° a spodním vnějším G-závitem s o-kroužkem								
Obj. č.	T1 závit JIC 37°	T2 závit JIC 37°	T3 závit BSPP	L1 (mm)	L2 (mm)	L3 (mm)	S (mm)	S1 (mm)
HJ09-71618	JIC 7/16"-20	JIC 7/16"-20	G 1/8"	23	23	27	11	14
HJ09-91614	JIC 9/16"-18	JIC 9/16"-18	G 1/4"	27	27	32	14	19
HJ09-3438	JIC 3/4"-16	JIC 3/4"-16	G 3/8"	32	32	37	19	22
HJ09-3412	JIC 3/4"-16	JIC 3/4"-16	G 1/2"	34	34	44	22	27
HJ09-7812	JIC 7/8"-14	JIC 7/8"-14	G 1/2"	27	27	43	22	27
HJ09-171634	JIC 1 1/16"-12	JIC 1 1/16"-12	G 3/4"	42	42	50	27	36
HJ09-211610	JIC 1 5/16"-12	JIC 1 5/16"-12	G 1"	46	46	52	33	41

