

Features

- ◇ Many sizes for workpiece with different shapes and sizes.
- ◇ Large inside support in order to avoid wrinkles when it sucks paper and plastic film.
- ◇ At high temperature, it can be mark free.

Applications

- ◇ Plastic film, paper.
- ◇ Wood sheet, solar wafer.



Specification

Model	Diameter (mm)	Material and color	Connection thread
SFT	15	S-silicone(white) HTI-high temperature material(blue) NR-nature silicone(beige)	M5M(Male thread) G1/8M(Male thread) G1/8F(Female thread) G1/4M(Male thread) G1/4F(Female thread)
	20		
	24		
	30		
	34		
	35		
	40		

△ SFT15S-M5M

How to Order

Model	Connection thread	vacuum pad	M5M	G1/8M	G1/8F	G1/4M	G1/4F
		without fitting	(Male thread)	(Male thread)	(Female thread)	(Male thread)	(Female thread)
SFT15S		239.0151.0000	239.0151.0500	239.0151.0100	239.0151.1100	-	-
SFT15HT1		239.0152.0000	239.0152.0500	239.0152.0100	239.0152.1100	-	-
SFT15NR		239.0153.0000	239.0153.0500	239.0153.0100	239.0153.1100	-	-
SFT20S		239.0201.0000	239.0201.0500	239.0201.0100	239.0201.1100	-	-
SFT20HT1		239.0202.0000	239.0202.0500	239.0202.0100	-	-	-
SFT20NR		239.0203.0000	239.0203.0500	239.0203.0100	239.0203.1100	-	-
SFT24S		239.0241.0000	239.0241.0500	239.0241.0100	239.0241.1100	-	-
SFT24HT1		239.0242.0000	239.0242.0500	239.0242.0100	239.0242.1100	-	-
SFT24NR		239.0243.0000	239.0243.0500	239.0243.0100	239.0243.1100	-	-
SFT30S		239.0301.0000	-	-	-	239.0301.0200	239.0301.1200
SFT30HT1		239.0302.0000	-	-	-	239.0302.0200	239.0302.1200
SFT30NR		239.0303.0000	-	-	-	239.0303.0200	239.0303.1200
SFT34S		239.0341.0000	-	-	-	239.0341.0200	239.0341.1200
SFT34HT1		239.0342.0000	-	-	-	239.0342.0200	239.0342.1200
SFT34NR		239.0343.0000	-	-	-	239.0343.0200	239.0343.1200
SFT35S		239.0351.0000	-	-	-	239.0351.0200	239.0351.1200
SFT35HT1		239.0352.0000	-	-	-	239.0352.0200	239.0352.1200
SFT35NR		239.0353.0000	-	-	-	239.0353.0200	239.0353.1200
SFT40S		239.0401.0000	-	239.0401.0100	-	239.0401.0200	239.0401.1200
SFT40HT1		239.0402.0000	-	239.0402.0100	-	239.0402.0200	239.0402.1200
SFT40NR		239.0403.0000	-	239.0403.0100	-	239.0403.0200	239.0403.1200

How to Order Vacuum Pad Fitting

Model \ Connection thread	M5M (Male thread)	G1/8M (Male thread)	G1/8F (Female thread)	G1/4M (Male thread)	G1/4F (Female thread)
SFT15	502.2390.0500	502.2390.0100	502.2390.1100	-	-
SFT20	502.2390.0500	502.2390.0100	502.2390.1100	-	-
SFT24	502.2390.0500	502.2390.0100	502.2390.1100	-	-
SFT30	-	-	-	502.2391.0200	502.2391.1200
SFT34	-	-	-	502.2391.0200	502.2391.1200
SFT35	-	-	-	502.2392.0200	502.2392.1200
SFT40	-	502.2393.0100	-	502.2393.0200	502.2393.1200

Performance

Model	Suction force(N)	Inner volume(cm ³)	Recommended tube diameter(mm)	Weight(g)
SFT15	5.5	0.13	2	0.7
SFT20	8.5	0.30	2	1.1
SFT24	11	0.72	4	1.2
SFT30	19	1.50	4	3.3
SFT34	25	2.0	4	3.7
SFT35	31	2.10	4	6.5
SFT40	33	3.0	4	5.1

△ Workpiece with dry and smooth surface, above suction force does not include safety factor, value will change according to different condition of workpiece.
 △ Recommended tube length is 2.0m.

Dimensions (mm)

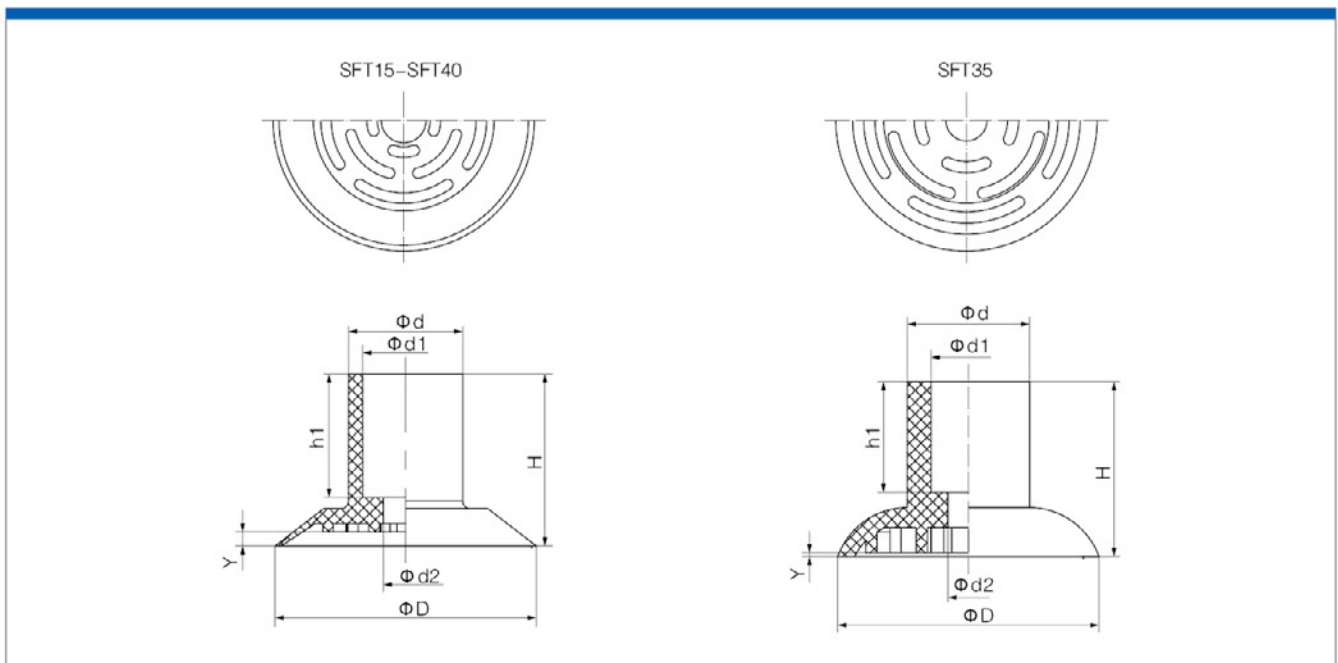

- TXC
- TXM
- SNP
- SOP
- SB
- SBF
- SBOF
- SFT**
- SBL
- SBLP
- SF
- SU
- SUF
- STC
- SFF
- SOB
- SOF
- SOG
- SFP
- SBP
- SXP
- SGP
- SDL
- SD
- SH
- SHB
- AZP
- AZPT
- AZPR
- SAN
- SAO
- SAOT
- SAOR
- SPA
- SPC
- SPF
- SPJ
- SPJG
- SPS
- SPU
- SNT
- K
- Fittings for Vacuum Pads
- BH
- Bulkhead Connector
- Ball Joint

Dimensions (mm)

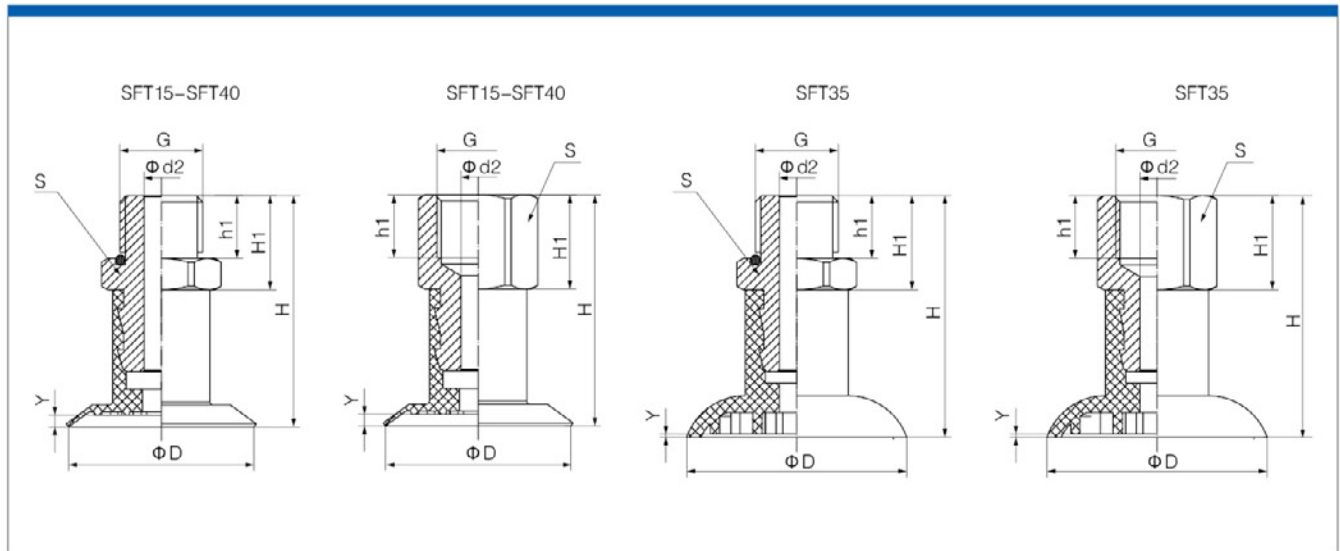

Model \ Dimension	ΦD	H	Φd	Φd1	h1	Φd2	H1	Y	G	S
SFT15	14.5	10	9	4.5	7.2	3.5	-	0.9	-	-
SFT15-M5M	14.5	20	-	-	5	2.5	10	0.9	M5	7
SFT15-G1/8F	14.5	22	-	-	8	3.5	12	0.9	G1/8	14
SFT15-G1/8M	14.5	23.5	-	-	7.5	3.5	13.5	0.9	G1/8	14
SFT20	20.9	10.4	10.5	4.5	7.2	3.5	-	1.5	-	-
SFT20-M5M	20.9	20.4	-	-	5	2.5	10	1.5	M5	7
SFT20-G1/8F	20.9	22.4	-	-	8	3.5	12	1.5	G1/8	14
SFT20-G1/8M	20.9	23.9	-	-	7.5	3.5	13.5	1.5	G1/8	14
SFT24	24.4	10.8	10	4.5	7.2	3.5	-	1.7	-	-
SFT24-M5M	24.4	20.8	-	-	5	2.5	10	1.7	M5	7
SFT24-G1/8F	24.4	22.8	-	-	8	3.5	12	1.7	G1/8	14
SFT24-G1/8M	24.4	24.3	-	-	7.5	3.5	13.5	1.7	G1/8	14
SFT30	30.6	22.2	15.6	11.2	15.7	6.6	-	2	-	-
SFT30-G1/4F	30.6	37.2	-	-	10	5.5	15	2	G1/4	17
SFT30-G1/4M	30.6	37.2	-	-	10	5.5	15	2	G1/4	17
SFT34	34.5	23	14.8	11.2	16.8	5.8	-	2	-	-
SFT34-G1/4F	34.5	38	-	-	10	5.5	15	1.4	G1/4	17
SFT34-G1/4M	34.5	38	-	-	10	5.5	15	1.4	G1/4	17
SFT35	35	23.5	16.5	10	14.8	5.4	-	1.4	-	-
SFT35-G1/4F	35	38.5	-	-	10	5.5	15	0.5	G1/4	17
SFT35-G1/4M	35	38.5	-	-	10	5.5	15	0.5	G1/4	17
SFT40	40.5	20.6	16	8	14.5	5	-	0.5	-	-
SFT40-G1/8M	40.5	34.1	-	-	7.5	3.5	13.5	2.3	G1/8	17
SFT40-G1/4F	40.5	35.6	-	-	10	5.5	15	2.3	G1/4	17
SFT40-G1/4M	40.5	35.6	-	-	10	5.5	15	2.3	G1/4	17