

Pressure Regulator Brass standard

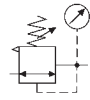

274.663

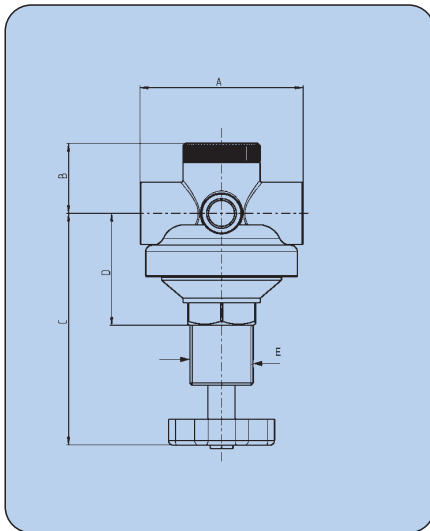

Dimensions [mm]

Size Port	Small G ¹ / ₄	Medium G ¹ / ₂
A	45	72
B	23	30
C	81	115
D	35	52
E	M20x1,5	M28x1,5

Pressure regulators (diaphragm type). Port size G¹/₄ and G¹/₂. Secondary air exhaust (relieving) and almost complete independence of primary pressure. Working pressure ranges 0,5 to 3, 6, 10, 16 and 25bar. Adjustment by means of a locknut. Gauge can be mounted on either side. Panel mounting or bracket mounting upon request.

Important: Use of filter always recommended.

Technical data

	Small	Medium
Nominal rates of flow*	430NI/min	1250NI/min
Max. inlet pressure (P ₁)	40 bar (PN40)	
Operating temperature	-10°C to +90°C	
Outlet pressure range (P ₂)	0,5 to 3, 6, 10, 16 and 25bar	
Mounting position	any	
Direction of flow	arrow	
Nominal width	DN6	DN12
Dependence upon supply pressure	< 10%	< 4%
Reversing control hysteresis	~ 1 bar	
Weight	390g	1000g
Material	NBR	
Diaphragm/Seals	brass	

* measured at p₁ = 8bar, p₂ = 6bar and Δp = 1 bar

Also to be used with neutral and non-toxic gases

Pressure Regulators Brass 0,5-10bar

Size	G ¹ / ₄	G ¹ / ₂
Small	286.323	-
Medium	-	274.663

special option - how to order:

274.xxx

1	- 0,5 - 3bar	operating pressure range
2	- 0,5 - 6bar	
3	- 0,5 - 10bar	
4	- 0,5 - 16bar	
5	- 0,5 - 25bar	
	- thread (2 = G ¹ / ₄ , 6 = G ¹ / ₂)	
3	- with pressure gauge (Model 286) (not at 25 bar)	
6	- with pressure gauge (Model 274)	
4	- without pressure gauge	

For example:

274.663 – but without pressure gauge and 0,5-16bar = 274.464

Accessories

	Small	Medium
Bracket mounting	286-88	274-48
Panel mounting	286-89	274-49

Main spare parts

	Small	Medium
Pressure gauge	ø40	ø63
display range 0- 6bar	714	213
0-10bar	723	214
0-16bar	734	215
0-25bar	745	216
0-40bar	-	217
Seal cone complete	286-120	274-75
Diaphragm complete 0- 3bar	286-126	274-65
0-10bar	286-126	274-66
0-25bar	286-126	274-67

Rates of flow p₁=p₂+2bar

